

Suite 400
SCALE: N.T.S.
(11x17)

1,740 RSF

LetLend:

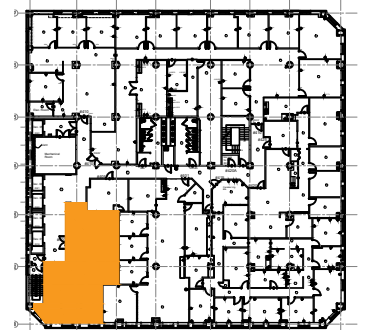

KeyPlan

no.	issue	date

Title:
4th Floor Plan

Scale: N.T.S.

Drawn By:

Date:

Project Name and Location/

80 Monroe Avenue

Memphis, TN 38103

Suite/Room #

Suite #400



1004 East Brooks Road
Memphis, TN 38116
Tel: 1-888-OLYMBEC
WWW.OLYMBEC.COM

*Note That All Dimensions Are Approximate and subject to change without notice